

These plans are conditionally approved as submitted or noted on drawings and are subject to field inspection. Approved plans must be kept on site and are needed for all inspections. No changes or modifications to these plans. Changes require a revision permit with the revised drawings. Permits are required for trades such as Electrical or Plumbing.

Electrical Review - Alina Mahmood - 10-24-2017
 Plumbing Review - Wayne Ferguson - 10-24-2017
 Elevator Review - Luchi Lu - 10-24-2017
 DDOT Review - Tiffany Tenbrock - 10-24-2017
 Mechanical Review - Wayne Ferguson - 10-24-2017
 DOE SE-SW Review - Nykia Biles - 10-24-2017
 Energy Review - Robert Campbell - 10-24-2017
 Fire Review - Luchi Lu - 10-24-2017
 Structural Review - Abdul Mujib - 10-24-2017
 DC Water Review - Wahid Bilal - 10-24-2017

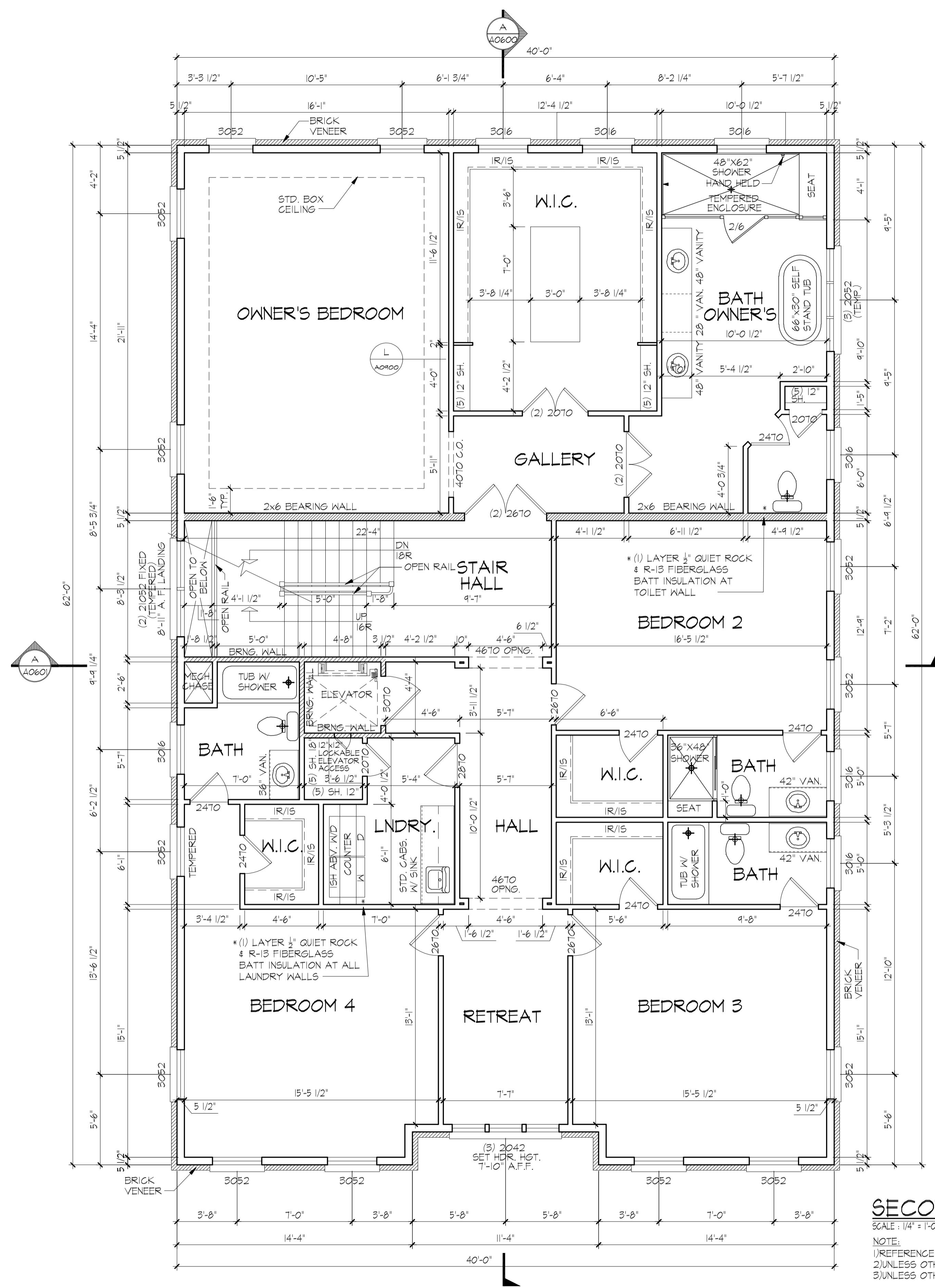

SECOND FLOOR PLAN

SCALE: 1/4" = 1'-0"
 NOTE:
 1) REFERENCE TYPICAL WALL SECTION FOR ADDITIONAL INFORMATION.
 2) UNLESS OTHERWISE NOTED WINDOW HEAD HEIGHT SHALL BE 7'-4" ABOVE SUBFLOOR.
 3) UNLESS OTHERWISE NOTED ALL INTERIOR PARTITIONS SHALL BE 3'-1/2"

SHEET TITLE:
SECOND FLOOR PLAN
4517 HOBAN RD. NW WASHINGTON, DC 20007
FOXHALL BUILDERS LLC - A & T LOT #875 SQUARE 1346

DRAWN BY:
 MAQ

06/07/2017

REV No. DATE

SHEET No.

40301

This drawing is an instrument of service and shall remain the property of Pinnacle Design & Consulting, Inc., it shall not be modified or reproduced in any manner without written permission of Pinnacle Design & Consulting, Inc.